



BELMOND

LES BATEAUX BELMOND

LES BATEAUX BELMOND



DISCOVER ONE OF THE MOST RELAXING AND LUXURIOUS WAYS TO EXPLORE FRANCE, CRUISING ITS BEAUTIFUL CANALS AND RIVERS ABOARD THE SEVEN BOATS THAT MAKE UP THE **BELMOND BOATS IN FRANCE FLEET**. SOAK UP THE SPLENDOR OF THE RIVERS AND CANALS THAT CRISS-CROSS THE COUNTRYSIDE, WHERE THE LANDSCAPE IS STUNNING, THE FOOD AND WINE MOUTHWATERING AND THE LOCALS ARE WARM AND WELCOMING.

THE BOATS

Our stunning boats accommodate between four and 12 guests in total comfort. Each are individually designed and some have heated, panoramic pools and sunbeds laid out on the attractive sun decks, while all are equipped with bicycles ready for riding along leafy pathways by the tranquil canals. All meals, beverages and excursions are included within your fare.

Relax in bright, airy lounges, gazing at the views through the large picture windows, or drink in the vistas from the sun deck – also perfect for cocktails before dinner.

Many of our seasoned staff are fluent in English and French. A personal guide is on board, ready to introduce you to the region's highlights. You'll be looked after by the barge's chef, too, who carefully pairs fresh regional cuisine with local wines and cheese.

A NEW VISION OF CHAMPAGNE EXCELLENCE

We are delighted to announce the newest addition to our luxury boat fleet, Coquelicot, A Belmond Boat, Champagne.

Coquelicot invites you to chart a novel course from

the luxury of the water and see Champagne from a fresh perspective. Elegant interiors are rich in details that honour the history and heritage of the locality, complementing the ever-changing views and creating an intimate sanctuary on the water. Top-deck dining, unforgettable experiences and an exclusive partnership with Ruinart, the world's oldest champagne house, take you deeper into the effervescence of the region.

WHAT'S INCLUDED

- VEHICLE TRANSFER OR TRAIN TRANSFER FROM PARIS TO THE BOAT (IF APPLICABLE). PRIVATE HIRE TRANSFERS ARE ALSO AVAILABLE FROM LYON AND GENEVA
- TABLE D'HÔTE MEALS – EACH WEEK'S MENU INCLUDES REGIONAL SPECIALITIES AND SEASONAL DELICACIES UNIQUE TO THE AREA YOU'RE CRUISING THROUGH
- COMPLIMENTARY BEVERAGES
- ACCOMMODATION
- EXCURSIONS STATED IN THE ITINERARY, FULLY ESCORTED BY THE EXPERIENCED ONBOARD GUIDE

EXCURSIONS

The essence of travel with Les Bateaux Belmond is that your time is relaxed and any excursions will be tailored to your personal tastes and requirements. Our itineraries include visits to local attractions, such as stately châteaux and bustling markets, with add-on activities such as hot-air ballooning. During the cruise, your boat is accompanied by an air-conditioned vehicle ready to take you and your private guide on your chosen tours.

CAPACITY

COQUELICOT:	PRIVATE HIRE, 6 GUESTS
PIVOINE:	PRIVATE HIRE, 8 GUESTS
LILAS:	PRIVATE HIRE, 8 GUESTS
AMARYLLIS:	PRIVATE HIRE, 8 GUESTS
FLEUR DE LYS:	PRIVATE HIRE, 6 GUESTS
ALOUETTE:	PRIVATE HIRE, 4 GUESTS
NAPOLÉON:	PRIVATE HIRE OR PER CABIN, 12 GUESTS

COQUELICOT, A BELMOND BOAT, CHAMPAGNE



COQUELICOT'S DESIGN IS AN EXQUISITE REFERENCE AND HOMAGE TO THE CHAMPAGNE REGION.

ON BOARD

Coquelicot, A Belmond Boat, Champagne is the newest addition to the luxury barge fleet. Designed by Humbert and Poyet, Coquelicot's design ethos captures the very essence of Champagne. Local fabrics in neutral, earthy tones and raw materials honour the region's agricultural heritage; fluted walls, a decadent master suite bathroom and sparkling finishes pay homage to the end product. The combination of contemporary furnishings, antique touches and local flourishes combine to offer an ageless vision of French refinement.

The deck is the crown of Coquelicot. Two lounges, an open kitchen and a shaded dining area offer a choice of spaces to unwind and soak up the ever-changing scenery. Antique lighting and iconic furnishings create a space of enduring style.



THE CABINS

Featuring three glamorous cabins with ensuite facilities, an indoor salon with an exceptional champagne bar stocked in accordance with the guests' taste, and an extensive outdoor deck for relaxing pursuits, sensational dining and sparkling conversations, Coquelicot will set a new standard of sophistication for slow-paced sailing in France.



CONFIGURATION

CAPACITY	6 guests, 5 crew
HIRE	Private hire
TOTAL LENGTH	128ft
WIDTH	16.6ft
DECKS	2
CABINS	3

DECK PLANS

Upper deck

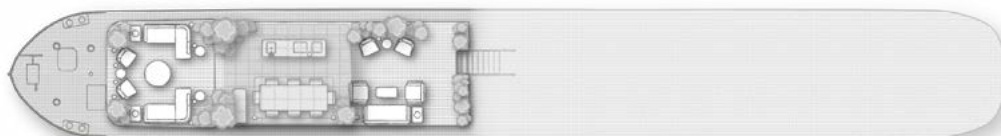

Lower deck



Illustrations not to scale

AMARYLLIS, A BELMOND BOAT, BURGUNDY



EXPLORE THE LUSH, FABLED WINE REGION OF BURGUNDY ABOARD OUR ELEGANT BOAT, WHICH CAPTURES BOTH THE CLASSIC STYLE AND EBULLIENT SPIRIT OF LA BELLE FRANCE.

DECK PLANS

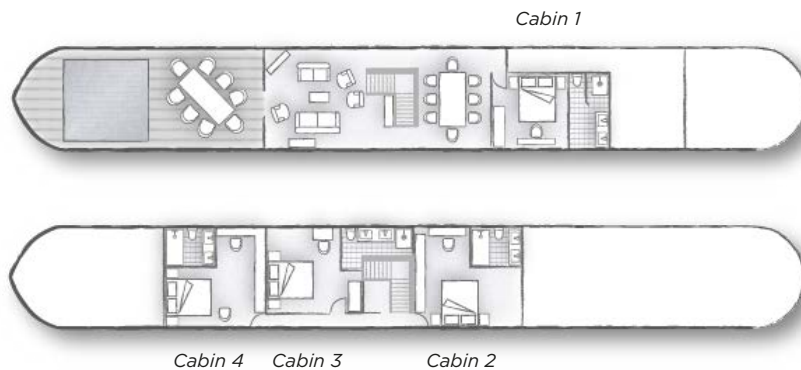

Illustrations not to scale

ON BOARD

Carrying up to eight passengers, Amaryllis, A Belmond Boat, Burgundy offers a taste of French splendour across two decks with its Louis XVI furniture, a Trompe-l'oeil wall mural and embroidered Parisian bedcovers. The emphasis on comfort and luxury is evident in our private cabins, which each offer king or twin beds and private marble en-suite bathrooms. While away sunny days in the heated pool or admire the picturesque landscapes from the sun deck. Dinner can be savoured in the formal dining room. In the lounge, doors span the width of the boat, opening for alfresco dining on the sun deck.

THE CABINS

Decorated by some of the most respected names in France and Italy, our four guest cabins are comfortable, beautifully equipped sanctuaries.

Facilities include:

- King-size bed (configured as twins if desired)
- En-suite bathroom with twin washbasins. Two of the bathrooms have a shower and two have a bathtub with overhead shower
- Bedside tables, dressing/desk table, chair, armchairs
- Wardrobe, safe and hairdryer
- Sockets suitable for two-pin 220-volt plugs
- Individually controlled air-conditioning/heating unit so you can adjust the temperature to your liking.



CONFIGURATION	
CAPACITY	8 guests, 6 crew
HIRE	Private hire or per cabin basis
TOTAL LENGTH	128ft/39m
WIDTH	16.57ft/5.05m
DECKS	2
CABINS	4

DECK 1	
CABIN (1)	11' 9" x 11' 3"
DECK 2	
CABIN (2)	15' 3" x 11' 7"
CABIN (3)	14' 8" x 12'
CABIN (4)	14' 8" x 15'

Bathroom Shower	8' 7" x 5' 6"
Bathroom bathtub with overhead shower	8' 8" x 5' 8"
Bathroom Shower	11' 8" x 5'
Bathroom bathtub with overhead shower	9' 5" x 6'

FLEUR DE LYS, A BELMOND BOAT, BURGUNDY



VISIT THE MAGNIFICENT CHÂTEAUX AND VINEYARDS AT THE HEART OF BURGUNDY ON BOARD THIS OPULENT, BOAT, WHICH ALLOWS UP TO SIX GUESTS TO SPREAD OUT IN STYLE.

DECK PLANS

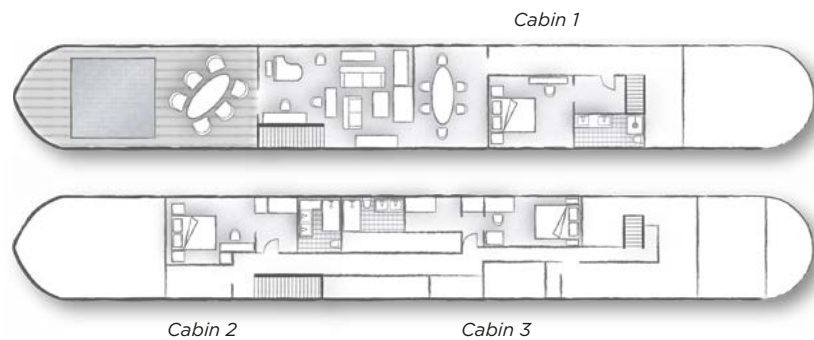

Illustrations not to scale

ON BOARD

From ornate fabrics to regal four-poster beds and authentic Indian furnishings, Fleur de Lys, A Belmond Boat, Burgundy is a visual treat – there’s even a baby grand piano for the musically minded to play in the lounge. Entertain yourself with a curated selection of games, books, music and movies and enjoy WiFi. By day, look out over panoramic vistas of the verdant countryside from the sun deck, or take a dip in the heated pool. As evening falls, dress for dinner in your private en-suite cabin and enjoy a sumptuous banquet created by your chef and served in the elegant dining room.

THE CABINS

The three guest cabins cocoon you in comfort. Each can be configured with twin or king-size beds, making Fleur de Lys perfect for families or groups travelling together.

- Facilities include:
- En-suite bathroom with twin washbasins, a 110-220-volt shaver socket, either a large corner shower or a bathtub with an overhead shower
 - Bedside tables, dressing/desk table and chair
 - Wardrobe, safe and hairdryer
 - Sockets suitable for two-pin 220-volt plugs
 - Individually controlled air-conditioning/heating unit so you can adjust the temperature to your liking.



CONFIGURATION	
CAPACITY	6 guests, 6 crew
HIRE	Private hire
TOTAL LENGTH	129ft/39.3m
WIDTH	16.57ft/5.05m
DECKS	2
CABINS	4

DECK 1	
CABIN (1)	13' 6" x 11' 2"
DECK 2	
CABIN (2)	14' x 9' 5"
CABIN (3)	14' 4" x 8' 5"

Bathroom Shower	10' 3" x 6' 2"
Dressing area	13' x 7' 9"
Bathroom bathtub with overhead shower	9' 5" x 6' 2"
Dressing area	9' 5" x 4' 9"
Bathroom bathtub with overhead shower	10' 1" x 5' 9"
Dressing area	8' 5" x 8' 2"

LILAS, A BELMOND BOAT, BURGUNDY



GLIDE THROUGH BURGUNDY ON OUR SLEEK AND BEAUTIFUL BOAT, WHICH OFFERS AN INTIMATE ATMOSPHERE AND BESPOKE SERVICE FOR JUST EIGHT PASSENGERS.

ON BOARD

Inspired by nature and named after the lilac flower, Lilas, A Belmond Boat, Burgundy gives classic French style a contemporary twist. Comfort is of the essence, and each of our spacious cabins offers king or twin beds and tiled en-suite bathrooms. To make the most of your chef's talents, the boat has an elegant dining room, as well as an airy lounge with doors that open out for alfresco dining. In the evening, enjoy an aperitif and your choice of music. Spend sunny days by the heated pool on deck and soak up the beauty of the countryside.

THE CABINS

- Lilas invites you to step into a world of understated elegance. Facilities include:
- King-size beds (configured as twins if desired)
 - En-suite bathrooms with twin washbasins and WC. One bathroom has a bathtub with an overhead shower and three have a walk-in shower
 - Bedside tables
 - Dressing/desk table with chair
 - Wardrobe and armchairs
 - Safe and hairdryer
 - Sockets suitable for two-pin 220-volt plugs
 - Individually controlled air-conditioning/heating unit so you can adjust the temperature to your liking.

DECK PLANS

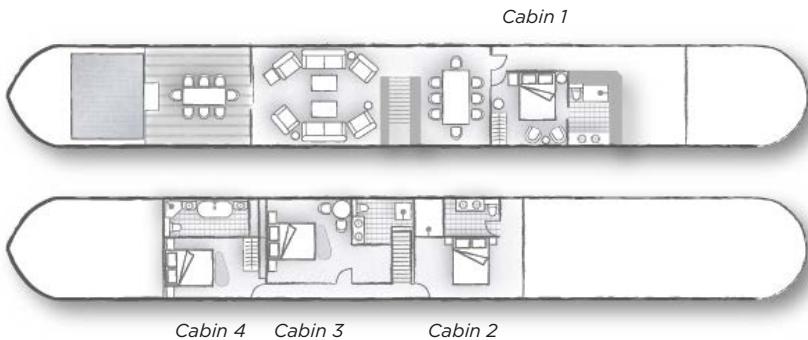

Illustrations not to scale

CONFIGURATION	
CAPACITY	8 guests, 6 crew
HIRE	Private hire or per cabin basis
TOTAL LENGTH:	100ft/30.48m
WIDTH	15.58ft/4.74m
DECKS	2
CABINS	4

DECK 1			
CABIN (1)	13' 5" x 11' 3"	Bathroom	6' 5" x 8' 7"
DECK 2			
CABIN (2)	14' 8" x 9' 4"	Bathroom	9' 4" x 4' 6"
CABIN (3)	12' 7" x 11' 4"	Bathroom	8' 9" x 6' 2"
CABIN (4)	15' 2" x 9' 4"	Bathroom	14' 9" x 5' 2"

NAPOLEON, A BELMOND BOAT, PROVENCE



UP TO 12 PASSENGERS CAN RELAX ABOARD GRAND NAPOLEON AS IT GLIDES FROM TAIN L'HERMITAGE TO AVIGNON VIA THE MAJESTIC RHÔNE.

ON BOARD

Napoléon, A Belmond Boat, Provence is ideal for large, convivial gatherings, with its six comfortable cabins each boasting an en-suite bathroom. In addition to an elegant dining room, there's a shaded area on the spacious sun deck where you can spend blissful hours soaking up the views or sip a cool drink and linger over a delicious alfresco lunch. Explore the wondrous sights of Provence by day; in the evening, sink into the onboard jacuzzi to watch the sun set, or swap stories over cocktails beneath the starry sky.

THE CABINS

Make yourself at home in our six generous guest cabins, each with picture windows. Facilities include:

- King-size beds (configured as twins if desired)
- En-suite bathrooms and 110-220-volt shaver socket
- Bedside tables, dressing/desk table with stool
- Wardrobe, safe, hairdryer
- Intercom and individually controlled air-conditioning/heating unit so you can adjust the temperature to your liking.

DECK PLANS

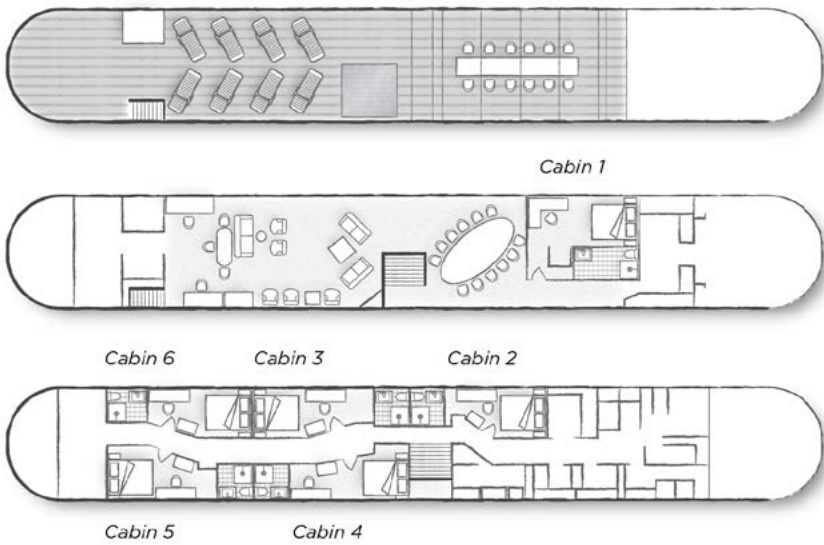

Illustrations not to scale

CONFIGURATION

CAPACITY	12 guests, 6 crew
HIRE	Private hire or per cabin basis
TOTAL LENGTH	129ft/39.3m
WIDTH	16.56ft/5.05m
DECKS	3
CABINS	6

DECK 1

Sun deck with 360-degree panoramic views

DECK 2

CABIN (1)	12' 5" x 7' 2"	Bathroom	9' 4" x 4' 3"
-----------	----------------	----------	---------------

DECK 3

CABIN (2)	14' x 7' 4"	Bathroom	8' x 4' 6"
CABIN (3)	14' 4" x 7' 5"	Bathroom	7' 5" x 4' 6"
CABIN (4)	14' x 7' 5"	Bathroom	8' x 4' 6"
CABIN (5)	13' 9" x 7' 8"	Bathroom	7' 9" x 4' 6"
CABIN (6)	14' x 7' 5"	Bathroom	6' x 4' 4"

PIVOINE, A BELMOND BOAT, CAMARGUE



DISCOVER THE JOYS OF THE CAMARGUE REGION. PIVOINE LAVISHLY ACCOMMODATES EIGHT GUESTS IN COOL, CONTEMPORARY STYLE.

ON BOARD

Named after the peony flower, Pivoine, A Belmond Boat, Camargue offers the ultimate in chic design and blissful comfort, combining soft tones with petal whites. Each light-filled cabin on this unique boat features a tiled en-suite bathroom and king or twin beds. The onboard dining room is perfect for a gourmet banquet. For breezy socialising, the lounge has full-width doors which open onto the generous deck for alfresco dining. Swim in the heated pool or relax in the shade of the canopy.

THE CABINS

- The four guest cabins are relaxing sanctuaries offering home-from-home comforts. Facilities include:
- King-size beds (configured as twins if desired)
 - En-suite bathrooms with twin washbasins and WC. One bathroom has a bathtub with an overhead shower and three have a walk-in shower
 - Bedside tables
 - Dressing/desk table with chair
 - Wardrobe
 - Armchairs
 - Safe and hairdryer
 - Sockets suitable for two-pin 220-volt plugs
 - Individually controlled air-conditioning/heating unit so you can adjust the temperature to your liking.

DECK PLANS

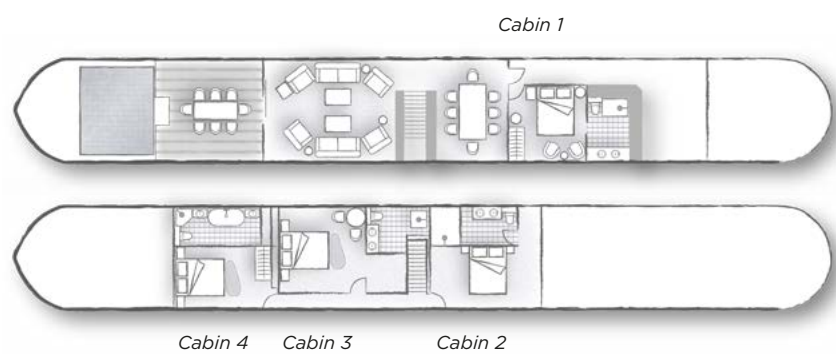

Illustrations not to scale

CONFIGURATION	
CAPACITY	8 guests, 6 crew
HIRE	Private hire or per cabin basis
TOTAL LENGTH	128ft/39m
WIDTH	16.57ft/5.05m
DECKS	2
CABINS	4

DECK 1			
CABIN (1)	13' 5" x 11' 3"	Bathroom	6' 5" x 8' 7"
DECK 2			
CABIN (2)	14' 8" x 9' 4"	Bathroom	9' 4" x 4' 6"
CABIN (3)	12' 7" x 11' 4"	Bathroom	8' 9" x 6' 2"
CABIN (4)	15' 2" x 9' 4"	Bathroom	14' 9" x 5' 2"

ALOUETTE, A BELMOND BOAT, CANAL DU MIDI



DRIFT ALONG THE SUN-DAPPLED CANAL DU MIDI, BETWEEN BÉZIERS AND CARCASSONNE, ABOARD OUR INTIMATE BOAT. WITH ROOM FOR UP TO FOUR GUESTS, IT'S PERFECT FOR A ROMANTIC BREAK OR A SMALL GROUP ADVENTURE.

ON BOARD

Winding along the tranquil Canal du Midi you can explore the Languedoc wine region and uncover the history of medieval fortresses – or simply enjoy the beautiful views, framed by our expansive picture windows. Alouette, A Belmond Boat, Canal du Midi offers two exquisite cabins, each with an en-suite shower and double or twin beds. Relax in reclining chairs on the sun deck beneath the hydraulic canopy or unwind in the spacious lounge and dining area.

THE CABINS

Decorated in soft pastels, our two cabins feature large windows to bring the romance of the Canal du Midi in. Facilities include:

- King-size bed (configured as twins if desired)
- En-suite bathroom with walk-in shower
- Bedside tables
- Safe and hairdryer
- Dressing/desk table, chair, armchairs
- Spacious wardrobe/storage space (including drawers)
- Sockets suitable for two-pin 220-volt plugs
- Bose iPod docking station
- Individually controlled air-conditioning and heating unit so you can adjust the temperature
- Wall-mounted screen for watching DVDs.

DECK PLANS

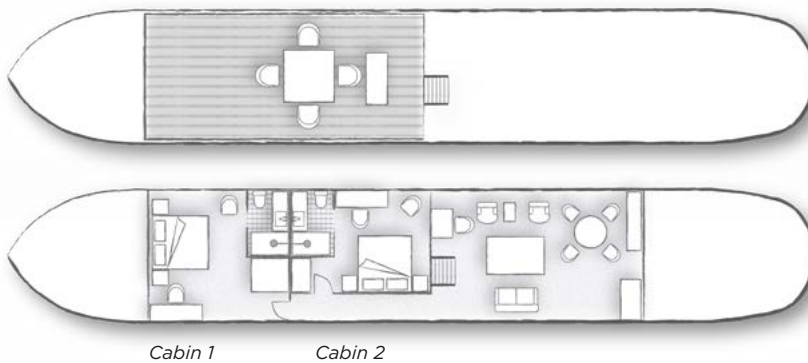

Illustrations not to scale



CONFIGURATION

CAPACITY	4 guests, 4 crew
HIRE	Private hire
TOTAL LENGTH:	100ft/30.48m
WIDTH	15.58ft/4.74m
DECKS	2
CABINS	2

DECK 1

Sun deck with 360-degree panoramic views

DECK 2

CABIN (1)	10' 11" x 14' 4"	Bathroom Shower	4' 2" x 6' 2"
CABIN (2)	9' 11" x 11'	Bathroom Shower	5' 11" x 4' 3"

LES BATEAUX BELMOND

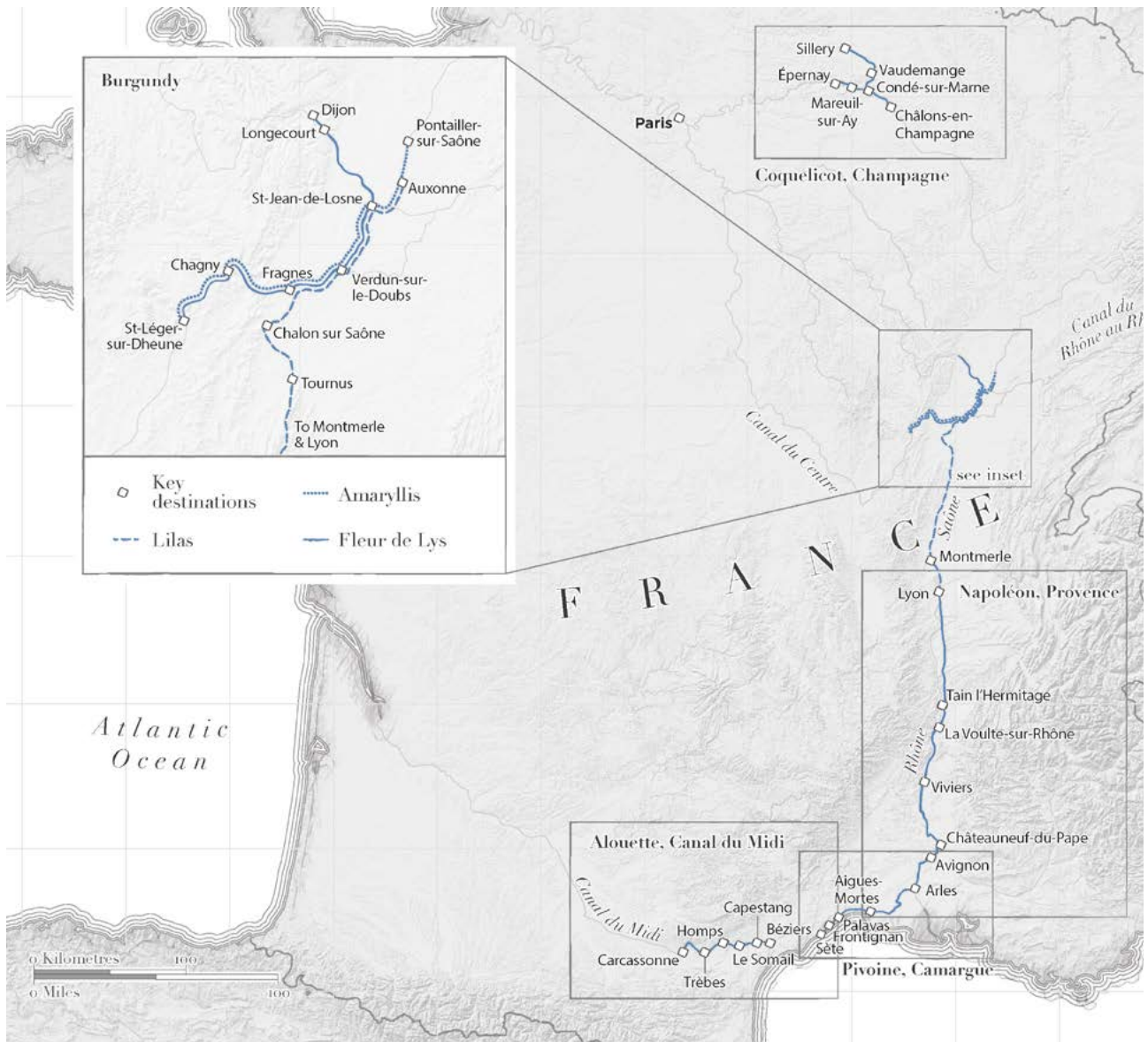

Routes shown are for guidance only and are subject to change

SEASON: APRIL TO OCTOBER

OUR JOURNEYS

Cruise along the Canal du Midi to the vineyards and villages of Burgundy, explore the culture and charm of Provence, Camargue or the effervescent delights of the Champagne region. Each of our boats is based in a different area. Regions we visit include Côte d'Or, Burgundy, Champagne, Franche-Comté, Saône, Provence, Vallée du Rhône and the Canal du Midi.

We offer a range of itineraries, from classic to customised, to suit every guest.

Whether you're planning a family holiday, a reunion with friends or a romantic escape, we can create your perfect journey. Hire an entire boat and let us tailor your itinerary, or simply join us on a per-cabin basis.



BELMOND

PLEASE CONTACT US FOR RESERVATIONS OR FURTHER INFORMATION. WE LOOK FORWARD TO HEARING FROM YOU.
BELMOND.COM/CONTACTUS